

CLASSIC FRAME (S-Series & C-Series) - BI-PASS

NO STOP profile

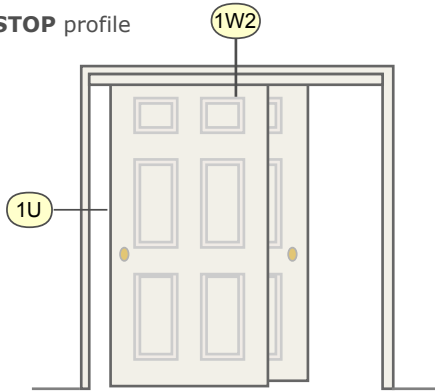

Classic Frame - **BI-PASS**

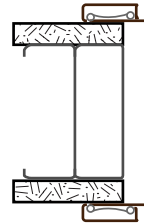

1U Jamb - No Stop

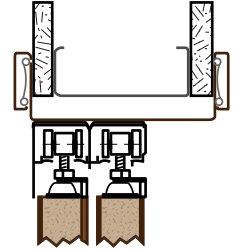

1W2 Header - Bi Pass

CLASSIC FRAME (S-Series & C-Series) - BI-PASS

RELATED INFORMATION

SOUND

FRAME MATERIALS	DOOR SIZE AND WEIGHT	JAMB DEPTH RANGES	RATINGS
Prefinished Steel	Door Thickness: 1 3/8" or 1 3/4" Max. Door Width: 10' - 0" Max. Door Height: 10' - 0" *	Standard Jamb Depths S-Series (20 gage): N/A C-Series (18 gage): N/A Custom Jamb Depths C-Series (18 gage): 3/4" to 13" in 1/8" increments.	Not Available

* Height on custom Jamb Depths is limited to 10' - 1"
 All widths and heights are inside dimensions - net door or glass opening size.

ROUGH OPENING DIMENSIONS

WIDTH

For a pair of Bi-Pass doors, the rough opening width is 1 1/4" larger than the total nominal width of the doors minus 1" for door overlap plus the width of any astragal mounted between the doors. If using a pair of 2'0" doors, the frame will be fabricated 3'11" inside width to accommodate door overlap.

Width is 2 x door width less 1"

ROUGH OPENING: Nominal Door width x 2 minus 1"
 for overlap + 1 1/4"

HEIGHT

For a pair of Bi Pass doors, the rough opening height is 1" over nominal height or 13/16" over net height. Since Timely standard frames are actually 3/16" longer than the nominal height (Timely 7'0" frames are actually 7'0 3/16" long)

Timely Standard Height - 3/16" over nominal height

ROUGH OPENING: Nominal height plus 1"

Net Height - for frames prepared to other manufacturers' locations

ROUGH OPENING: Nominal height plus 13/16"

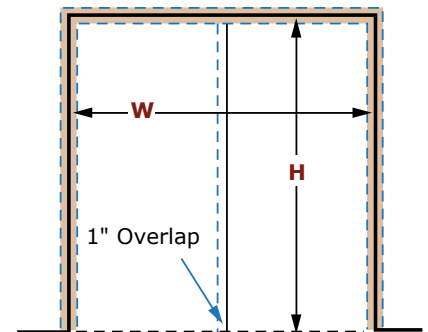

W = 2 x Door Width - 1" + 1 1/4"
H = Nominal height + 1"
 Net height + 13/16"