

DOUBLE EGRESS FRAME (DE-Series) - PAIR

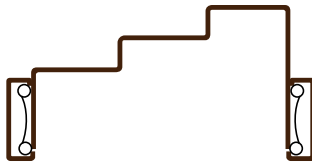

Shown with TA-8 Steel Casing as example.

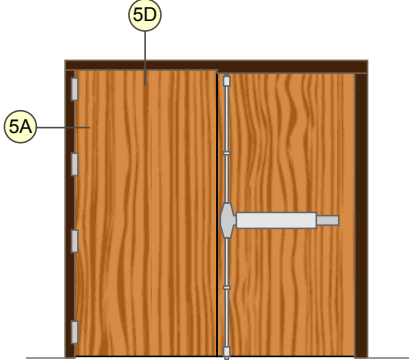

Double Egress Frame - **PAIR**



Left Hand Swing



Right Hand Swing

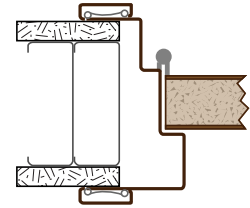

5A Jamb Hinge Side - Double Egress

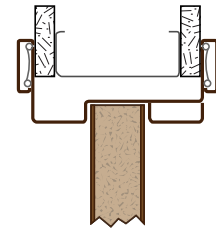

5D Header - Double Egress

DOUBLE EGRESS FRAME (DE-Series) - PAIR

RELATED INFORMATION

SOUND

FRAME MATERIALS	DOOR SIZE AND WEIGHT	JAMB DEPTH RANGES	RATINGS
Pre-Finished Steel	Door Thickness: 1 3/4" only Max. Door Weight: 250 Lbs. Max. Door Width: 2 X 4' - 0" Max. Door Height: 10' - 0"	Jamb Depths: 4 3/4" to 13" in 1/8" increments	Not Available

All widths and heights are inside dimensions - net door or glass opening size.

DOUBLE EGRESS FRAME (DE-Series) - PAIR

FIRE RATING

JAMB DEPTH RANGE	45, 90 MINUTE	GENERAL INFORMATION
Min. Jamb Depth: 4 7/8" Max. Jamb Depth: 13"	Max. Width: 8' - 0" Max. Height: 8' - 0"	<ol style="list-style-type: none"> All openings approved for Positive and Neutral pressure unless otherwise noted. All ratings apply to steel stud, wood stud, or masonry construction. All ratings approved for category "A" and "B" doors with category "G" edge sealing. Timely's fire rated <i>Metal "U" Insert</i> is recommended for masonry installations. If wood sub-frame is used in place of <i>Metal "U" Insert</i>, it will be necessary to use fire rated drywall on both sides of wood to maintain fire rating.

All dimensions shown are inside dimensions - net door opening size.

Distributors of Timely Frames may be approved to purchase labels and apply them to frames at their own facility. Intertek has set guidelines and a fee schedule for this program. Requirements and prices are available from Timely or Intertek.

- Wood, Aluminum or PVC casing does not affect ratings on door frames. Wood casing must be applied with hot melt glue or contact adhesive on 90 minute rated frames and on all glazed openings with 45 minute or 60 minute rating. On all other fire rated frames, wood casing can be applied with nails or finish head screws on jambs and mullions.
- Single frames must be prepared for strike or reinforced with (TA-48) for a rim exit device strike.
- Embossed WHI 90 min. label is available for Primer Galvanized Frames only.

DOUBLE EGRESS FRAME (DE-Series) - PAIR

ROUGH OPENING DIMENSIONS

WIDTH

For a pair of Double egress doors, the rough opening width is 2 1/2" larger than the total nominal width of the doors. Since the doors mount on the "stop" area rather than the "rabbet", the frame is actually 1 1/4" wider than a standard pair frame.

Width is sum of the nominal widths of both doors leaves

ROUGH OPENING: Nominal Door width(s) + astragal width (if mounted between the doors) + 2 1/2"

HEIGHT

For a pair of Double Egress doors, the rough opening height is 1" over nominal height or 13/16" over net height. Since Timely standard frames are actually 3/16" longer than the nominal height (Timely 7'0" frames are actually 7'0 3/16" long)

Timely Standard Height – 3/16" over nominal height

ROUGH OPENING: Nominal height plus 1"

Net Height – for frames prepared to other manufacturers' locations

ROUGH OPENING: Nominal height plus 13/16"

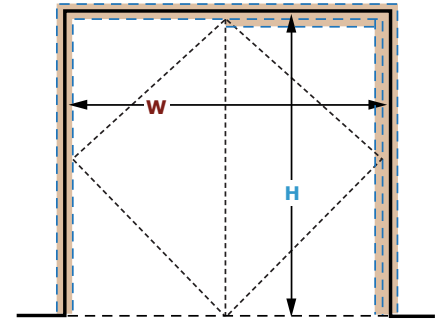

W = Nominal Door width(s) + astragal width (if mounted between the doors) + 2 1/2"

H = Timely nominal height + 1"
 Net height + 13/16"