

KERFED FRAME (CK-Series) - SINGLE

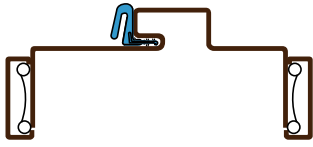

Shown with TA-8 Steel Casing as example.

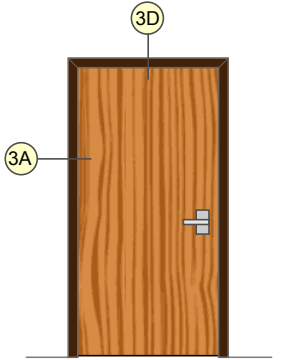

Kerfed Frame - **SINGLE**

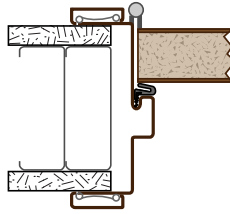

3A Jamb Hinge Side - Kerfed

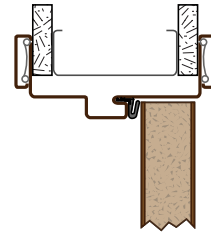

3D Header - Kerfed

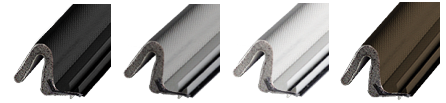

TA-46 Gasket: Weather Strip/Smoke Seal.
 Available in Black, Grey, White and Browntone.



TA-55 Intumescent Seal: Weather Strip/Smoke Seal and Intumescent Seal. Allows for use of Category B Fire Door.

Available in Black and Browntone.

KERFED FRAME (CK-Series) - SINGLE

RELATED INFORMATION

SOUND

FRAME MATERIALS	DOOR SIZE AND WEIGHT	JAMB DEPTH RANGES	RATINGS
Prefinished Steel	Max. Door Weight: 500 Lbs. Max. Door Width: 4' - 0" Max. Door Height: 10' - 0"	Jamb Depths: 4" to 8"	STC-28
DOOR THICKNESS			
1 3/4" only			
FRAME THICKNESS			
18 gage			

All widths and heights are inside dimensions - net door or glass opening size.

KERFED FRAME (CK-Series) - SINGLE

FIRE RATING

JAMB DEPTH RANGE	20 MINUTE*	45, 90 MINUTE	GENERAL INFORMATION
Min. Jamb Depth: 4"	Max. Width: 4' - 0"	Max. Width: 4' - 0"	1. All openings approved for Positive and Neutral pressure unless otherwise noted. 2. All ratings apply to steel stud, wood stud, or masonry construction. 3. All ratings approved for category "A" and "B" doors with category "G" edge sealing. 4. Timely's fire rated <i>Metal "U" Insert</i> is recommended for masonry installations. If wood subframe is used in place of <i>Metal "U" Insert</i> , it will be necessary to use fire rated drywall on both sides of wood to maintain fire rating. 5. Wood, Aluminum or PVC casing does not affect ratings on door frames. Wood casing must be applied with hot melt glue or contact adhesive on 90 minute rated frames and on all glazed openings with 45 minute or 60 minute rating. On all other fire rated frames, wood casing can be applied with nails or finish head screws on jambs and mullions. 6. Single frames must be prepared for strike or reinforced with (TA-47) for a rim exit device strike. 7. Embossed WHI 90 min. label is available for Primer Galvanized Frames only. 8. Metal 90 min. label riveted to frame is available.
Max. Jamb Depth: 8"	Max. Height: 10' - 0"	Max. Height: 9' - 0"	

All dimensions shown are inside dimensions - net door opening size.

* Tested and approved for Neutral Pressure only - not Positive Pressure approved.

Distributors of Timely Frames may be approved to purchase labels and apply them to frames at their own facility. Intertek has set guidelines and a fee schedule for this program. Requirements and prices are available from Timely or Intertek.

KERFED FRAME (CK-Series) - SINGLE

ROUGH OPENING DIMENSIONS

WIDTH

Rough opening width is 1 1/4" over nominal door width. This provides for 5/8" clearance between the jamb and the wall. This clearance is necessary for the pocket on the strike and the projection of the hinge screws. Frames can be installed with smaller opening widths but, in some cases, the framing must be relieved to provide the necessary clearance for plumbing the frame and installing the hardware. Opening width maximum is 1 7/8" which allows 5/16" of the frame face against the wall. For wider rough openings, the frame must be positioned with equal clearance on both sides. (Use oval alignment slots to adjust clearance when installing).

ROUGH OPENING WIDTH: Kerfed Frames (CK-Series) –
 Nominal door width + 1 1/4"

HEIGHT

Rough Opening height must provide clearance to level the header and interlock the jambs. Uneven floors will affect this measurement. Maximum space for adequate anchorage is 1 3/16" over net height resulting in approximately 5/16" of the frame face against the wall. While this is not recommended, the frame can still be installed.

Timely standard height - 3/16" over nominal.

ROUGH OPENING HEIGHT: Nominal Height + 1" (Net height +13/16")

Net Height – Frames manufactured to net heights

ROUGH OPENING HEIGHT: Net height + 13/16"

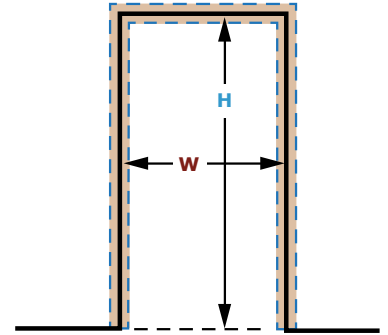

W = Nominal Width + 1 1/4"

H = Nominal Height + 1"
 (Timely standard height)

H = Net Height + 13/16"
 (All other frame specs)