



*Prepainted finishes and a positive pressure fire rating sold the builders of the ISC office/warehouse on Timely steel door frames. The strength and durability of Timely frames were important features for the high-abuse doorways between offices and warehouse. Easy installation was another plus for Timely. The 20,000 sq. ft. metal building is in the Richmond, Virginia area.*



**Keep up with new products, innovations, applications and specifications plus the latest CAD/CAM drawings at:**

**WWW.TIMELYFRAMES.COM**

**TIMELY INDUSTRIES LIMITED WARRANTY**

S.D.S. Industries, Inc., a California Corporation D.B.A. Timely Industries (hereafter called Timely), warrants to the original consumer purchaser that its Timely Prefinished Steel Door Frame when utilized for interior frame use, will be free from defects in material and workmanship for a period of one year from the date of purchase.

This warranty is applicable only when the products covered by it:

- 1) have been installed in accordance with the recommended written installation instructions of Timely Industries and with established building practices.
- 2) have been accorded treatment which is considered good practice in the Building Industry regarding storage and maintenance.
- 3) have been subjected only to normal use because Timely Industries cannot control the manner in which its products are handled after leaving its premises. This warranty does not apply to the finish or accessories of any product and shall not apply to any frame exposed to a corrosive or humid environment.

ANY AND ALL IMPLIED WARRANTIES APPLICABLE HERETO ARE LIMITED TO ONE

YEAR FROM THE DATE OF PURCHASE. Some states do not allow limitations on how long an implied warranty lasts, so the above time limitation may not apply to you. In the event the original consumer purchaser of any Timely Industries Prefinished Steel Door Frame believes that the frame or any parts thereof covered by this warranty are defective, a letter outlining the alleged defect should be sent postage prepaid to the following address:

TIMELY INDUSTRIES, 10241 NORRIS AVENUE, PACOIMA, CA 91331

Any Timely Prefinished Steel Door Frame or any parts thereof covered by this warranty which, upon inspection by an authorized Representative of Timely Industries are found by said Representative to be defective, will at the option of Timely Industries either repair, replace, or refund the purchase price of the frame or component part. Liability is limited to repair, replacement, or refund and does not include labor, installation cost, or indirect or consequential damages of any nature. Some states do not allow the exclusion or limitation of incidental or consequential damages, so the above limitation or exclusion set forth in this paragraph may not apply to you.

**TECHNICAL SUPPORT**

Timely provides the services of a tool and die shop, a knowledgeable sales force and stocking distributors to satisfy your needs on time and at competitive prices. Additionally, the **Timely College** enables the company to maintain technical support programs at the highest level. On staff are certified trainers who conduct certification programs covering Timely's product line as well as installation training.

Through its college, Timely also develops authorized consultants and installers and conducts in-field nationwide training for distributor representatives, contractors, installers and architects. Inquire about the classes available in your area.

# PREFINISHED STEEL DOOR FRAMES

Timely will change your frame of mind.







Bob Day, President

*Serving Timely Customers...Nationwide*

*This ultra modern 80,000 square-foot manufacturing-distribution facility at our headquarters in Pacoima, California, plus an eastern distribution center in Cincinnati, Ohio, enable Timely to provide prompt, efficient deliveries to markets throughout the United States.*



*This ultra modern 80,000 square-foot manufacturing-distribution facility at our headquarters in Pacoima, California, plus an eastern distribution center in Cincinnati, Ohio, enable Timely to provide prompt, efficient deliveries to markets throughout the United States.*

Since Timely prefinished steel door frames were introduced over 30 years ago, they have earned the trust of architects, contractors, building owners and building product distributors nationwide. Timely installations are found in many of America's most prestigious commercial, industrial and residential buildings.

Key to this success is a willingness to commit the resources necessary to adapt technological innovations and develop systems and tooling that promise superior product performance. For example, comparison tests show that our unique wall anchoring system makes Timely frames as strong as the wall, assuring door-holding capacity greater than hollow metal frames.

Timely frames are also time-savers and cost-cutters. They are faster, easier to install and our prefinished frames eliminate the added expense and inconvenience involved in jobsite painting. They represent Timely's proud tradition of quality and durability.

Our superior product performance, efficiency and economy point to an important advantage of doing business with Timely. After earning a customer's trust, we focus on keeping it—by keeping our standards high.



**It all starts with service.**

*Timely's steady growth, though based on product quality, is service-driven. Experienced specialists in every department display the pride and professionalism that result in efficient order fulfillment to exact specifications and prompt, on-schedule delivery. This dedication to customer satisfaction extends to an ongoing search for opportunities to design and develop manufacturing equipment in-house that will raise the bar of quality and service even higher.*



TA-8 Standard Steel Casing





Over 200 entry door openings and all the public areas feature Timely door frames at Belmont Village, a senior living facility in Carol Stream, Illinois. Timely sidelites were also selected. Why Timely? Timely's TA-30 Colonial steel casing in the popular Western White finish offered a warm residential look while still providing the strength, security and fire ratings required by local building codes.



Timely's TA-8 casings were selected for Gilmore Associates' restoration of The Continental, The Hellman and The San Fernando Buildings in Los Angeles. The TA-8 casing was favored because it assured economy, ease of installation and required fire rating -- making it a modern-day choice for use in historic high-rise structures. The frames were prefinished in Timely's Alumaton<sup>TM</sup>, a color match for clear anodized aluminum.

## An Array of Design Options

Timely supplies frames with design flexibility to meet the most stringent commercial, industrial and residential requirements. The remarkably versatile Timely line features distinctive door frame casing profiles in steel, aluminum and PVC shown here. Plus, it offers an option to use wood trims of your choice and an unlimited selection of colors complementing doors pre-machined to Timely's specifications. Our patented sustained tension snap-lock clips permit use of our various prefinished casings. The clips hold these casings secure and flush against the wall, eliminating gaps caused by uneven surfaces, as well as creating tight miters. On the TA-8 casing, the Timely MiterGard<sup>TM</sup> offers additional open-miter protection. And Timely's unique full perimeter anchoring system furnishes far greater frame strength and integrity than hollow metal.



**TA-8 Standard Steel Casing**, widely admired for its classic profile, enhances any commercial and residential setting. Features Timely's MiterGard<sup>TM</sup>

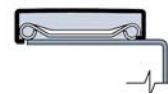

**TA-30 Colonial Steel Casing** adds that special warmth which distinguishes quality-built assisted living, hotels and motels, offices, apartments and homes. New TA-31N corner piece also featured.



**TA-35 PVC Colonial Casing**, a delicately defined extruded PVC molding, is quickly applied to Timely's clip system. Painted or in wood grain finishes.



**TA-23 Aluminum Casing** displays the crisp lines of an aluminum trim, while providing the economy and strength of steel.

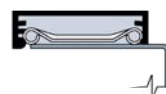

**TA-28 Aluminum Casing** is a full width aluminum casing without a reveal offering the advantages of a steel door frame.



**Wood Trim**  
Even wood trims from outside suppliers can be easily attached to the basic steel frame using nails or trim head screws without the need for special millwork.

## Color Coordination Offers Design Flexibility

Successful color coordination is easily achieved with Timely's basic selection of six stocking designer colors and 29 custom colors as well as **prime**. Timely can also match any color upon request. And quality is assured, because all colors are applied in coil form with a durable baked-on polyester finish. Powder coat finishes are available for special applications.

An important advantage of Timely's prefinished frames is a saving in jobsite painting costs of \$25 to \$50 per opening—plus the guarantee of color uniformity throughout the installation. Prefinishing also permits installation after walls are finished to avoid costly delays and wall damage. Spills, inadequate prepping, poor workmanship and touch-ups are problems of the past. So are the possible environmental problems. Timely frames are painted under controlled conditions to protect air, water and land from pollution.

Timely frames can also be protected against environmental hazards such as rust and corrosion from chemicals and high humidity. Just specify electro-galvanized frames.



## Optimum Safety-Engineering

Timely prefinished frames are engineered to deliver a 90-minute positive pressure fire rating for wood/steel stud drywall or masonry wall construction. Frames have undergone testing by Warnock Hersey International. They are labeled fire rated Category "A" door or Category "B" door with approved Category "G" edge-sealing system.



## MiterGard<sup>TM</sup> - The Open Miter Fighter

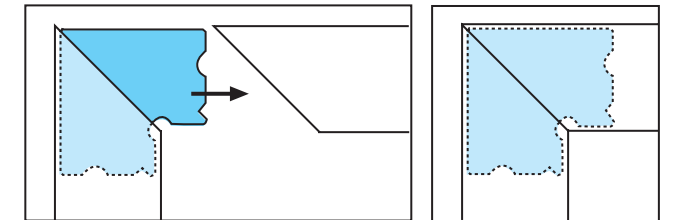

MiterGard<sup>TM</sup> is factory-attached to vertical casing. Exposed section slides securely into header casing.

MiterGard produces tight miters every time--with this built-in corner piece. The reason: its "L" shaped component is attached to the vertical door frame casings at the Timely factory. Pre-assembly makes it an integral part of the casing and, therefore, stronger and more accurate. MiterGard's exposed sections slide into the header casing for a precise fit. When installed according to factory instructions, it guards against errors that cause open miters and solves future open miter problems resulting from building movement or constant door operation. Designed exclusively for Timely's Model TA-8 casing, MiterGard reduces field labor costs through less handling.



## Innovative Casing Clip Sets The Standard

Timely's patented casing attachment clips reflect the company's leadership in steel door frame technology. These unique clips are designed to compensate for surface distortion, eliminating ugly gaps. Their "snap-lock" feature makes casings removable, permitting a change of color combinations if desired. For utmost strength, clips are formed burr-free from "mild steel." They are then case hardened, carbonized and zinc coated for rust resistance and lubrication.





Liberty Square Condos, developed by Hartz Construction in Chicago's western suburb of Lombard, Illinois, chose Timely's fire-rated frames for their flexibility. The condo units' door frames feature 3 1/2" wood colonial casings, while Timely's TA-8 steel casings were used in the stairwells. Timely "A" Series Adjustable Frames were specified to allow for various wall sizes and applications throughout the buildings. And, they were shipped pre-hung with six panel fire-rated metal doors --both are impossible tasks for hollow metal frames.



At the La Quinta Hotel in Stockbridge, Georgia, more than 200 door openings and over 20 interior windows were specified for Timely steel frames. The reasons: Prepainted finishes permitted faster, easier installations. And, Timely Series A adjustable frames saved installation time by accommodating final wall size changes.

## High Performance Features

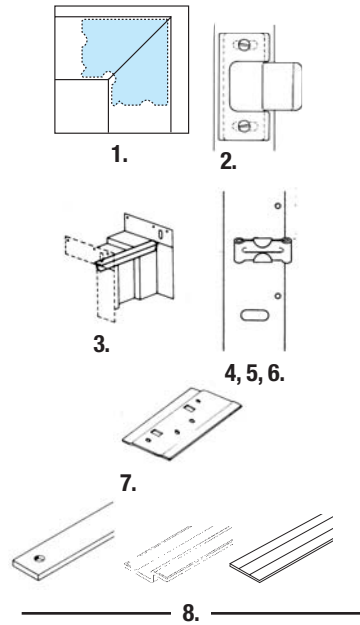

The total opening concept from Timely incorporates unique features, adding up to economical, attractive and stronger door installations.

- 1. Casing Corner Connector** holds mitered corners tight. MiterGard™ featured on TA-8 casings.
- 2. Adjustable Strike** permits full 1/4" adjustment, assures positive, rattle-free fit.
- 3. Full Width Aligning Tabs** correctly align uprights and header.
- 4. Pre-punched Fastener Holes** mean easier fastening.
- 5. Individually Attached Casing Clips** assure a snug casing fit that follows the irregularity of walls.
- 6. Alignment Slot** oval punch-outs allow visual check of frame spacing and adjustment during installation.
- 7. 14 Ga. Hinge Reinforcement Plates** are factory attached to give hinge strength of a 12 ga. frame.
- 8. TA-10, TA-12, TA-25 Reinforcement Brackets** are for door guards, closers and other hardware applications.

## Adjustable Frame

Timely's slide guide system allows its Adjustable Frame to accommodate any wall thickness from 3 3/4" to 9 1/8" with only 3 closure strips. It can be prehung or used as a standard drywall frame. Available in Browntone, Western White or Black powder coat finish, the adjustable frame is used with 1 3/4" doors only.



## Matchless Construction Versatility

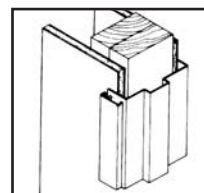

Timely prefinished door frames can be attached to virtually any construction material including wood stud and drywall (as illustrated here) plus:

- Wood Stud/Stucco/Drywall
- Wood Stud/Brick/Drywall
- Steel Stud & Drywall
- Masonry/Sub-buck
- (Adjustable Frame) Wood Stud/Drywall/Sound Board
- Traditional Wood Stud/Drywall

In most common wall construction, the job involves sleeving the frame over the wall, hanging the premachined door, fastening the frame and snapping on the casing. In addition to fast positioning, Timely frames provide accurate fit.

## Economy Plus Easy Installation

Costly jobsite labor is avoided when Timely prefinished steel frames are used with premachined doors. Only one-man is required for the frame installation which is usually completed in less than 15 minutes.



## Framing Specifications

Walls and floors may be finished before installing doors and frames. Measure height from finished, not rough floor. A minimum 2" stub wall is required on both sides of the rough opening for solid anchoring. For sub-buck applications (masonry, tilt-up concrete) rough opening is door width plus 4", door height plus 2 1/4".

### Rough Opening Dimensions

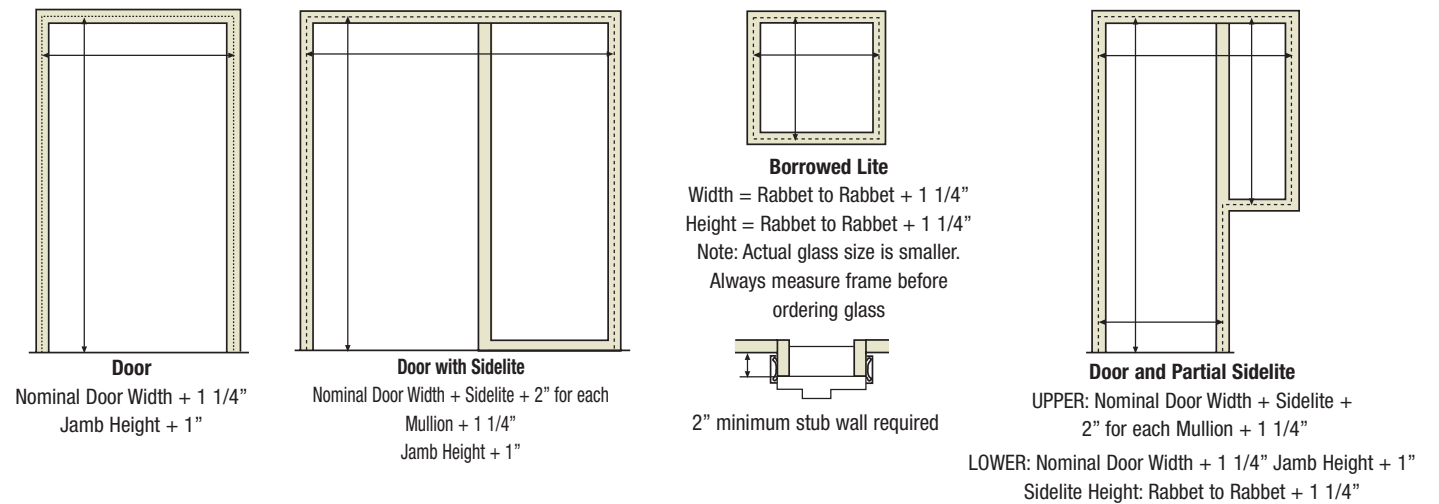

## Code Acceptability, Certification

### SINGLE SWING FRAMES

	MAXIMUM OPENING SIZE		WALL SIZE		FRAME SERIES
	WIDTH	HEIGHT	MIN	MAX	
20 MIN. * 45 MIN. "C" LABEL 90 MIN. "B" LABEL	4/0	10/0	3 3/8"	13"	C
	4/0	9/0	3 3/8"	13"	S,C,M,A,** E
	4/0	9/0	3 3/8"	13"	S,C,M,A,** E

\*Negative pressure only  
\*\* Maximum opening 4/0 x 8/0

### FULL BOUND WITH DOOR

	MAXIMUM OPENING SIZE		WALL SIZE		FRAME SERIES
	WIDTH	HEIGHT	MIN	MAX	
45 MIN. "C" LABEL 90 MIN. "B" LABEL	4/0	5/0	3 3/4"	13"	S,C,E
	4/0	5/0	3 3/4"	13"	C

### PAIR FRAMES

	MAXIMUM OPENING SIZE		WALL SIZE		FRAME SERIES
	WIDTH	HEIGHT	MIN	MAX	
20 MIN. 45 MIN. "C" LABEL 90 MIN. "B" LABEL	For 20 Min. Pair, use C Label Requirements				
	8/0	9/0	3 3/8"	13"	S,M,C,E
	8/0	9/0	3 3/8"	13"	S,M,C,E

### ADJUSTABLE PAIR FRAMES

	MAXIMUM OPENING SIZE		WALL SIZE		FRAME SERIES
	WIDTH	HEIGHT	MIN	MAX	
45 MIN. "C" LABEL 90 MIN. "B" LABEL	8/0	8/0	3 3/4"	9 1/8"	A
	8/0	8/0	3 3/4"	9 1/8"	A

### GENERAL INFORMATION

All ratings are usable for steel stud, wood stud, or masonry construction (steel sub-buck).

When using a wood sub-buck in place of Timely's metal insert for masonry construction, drywall must be used on both sides.

Single frames not prepared for strikes must use TA-12 rim panic strike reinforcement.

Reinforcements are required when using door closers to maintain fire ratings.

Fire ratings not approved for 1 3/8" frames.

All ratings approved for category "A" and "B" doors with category "G" edge sealing.

Solid brass not rated.



### SIDELITE, BORROWED LITE AND GLAZED TRANSOMS "S" or "C" GAUGE.

Wood Casing permitted on sidelites or borrowed lites for 20 Min. without vertical or horizontal mullions in glass area.

GLASS STOP SIZE	RATING	MAX ASSEMBLY SIZE 10'-1" W X 10'-1" H		WALL SIZE		MAX GLASS AREA
		WIDTH	HEIGHT	MIN	MAX	
1/2	45 MIN	24"	107"	3 3/8"	13"	*2568 SQ IN
**1/2	45 MIN	36"	54"	3 3/8"	13"	1296 SQ IN

NO STOP						
3/4	45 MIN	36"	54"	3 3/8"	13"	1296 SQ IN

GLASS STOP SIZE	RATING	MAX ASSEMBLY SIZE		MULLIONS NOT PERMITTED WALL SIZE		MAX GLASS AREA
		WIDTH	HEIGHT	MIN	MAX	
1/2	20 MIN	36"	36"	3 3/8"	13"	1296 SQ IN
***1/2	60 MIN†	36"	36"	3 3/8"	13"	1296 SQ IN

†Minutes negative pressure  
Do not exceed maximum assembly size.

\*Most building codes limit glass area to 1,296 sq. in. Do not exceed 1,296 sq. in. without verifying with local code authorities prior to specifying or ordering.

\*\*Must be caulked using 100% Pure Silicone Sealant.

\*\*\*Must use Firelite® glazing and install in a 5/8" wide glazing recess with 100% Pure Silicone Sealant.

All ratings cover positive or Negative Pressure except where indicated.

## Timely Sidelites and Borrowed Lites

The beauty and economy of the Timely frame sidelite and borrowed lite system are available to meet most glazed opening requirements. And because they're prefinished, they can be applied over finished walls. As a result, costly time delays and special fabrication are avoided.